

MODEL
RTQ 150

Retorquer

fascinating tops



This high-speed, continuous-motion retorquer reapplies cap torque after induction sealing at speeds up to 300 containers per minute to maximize line productivity.



- Heavy duty construction
- Stainless steel support frame
- Variable-speed holding belts
- Manual height adjustment
- Three sets of tightening discs
- Pneumatic torque control
- No-tool adjustment
- PLC controls
- Speeds up to 300 cpm



A Century of Packaging Expertise

Model RTQ 150 Retorquer

Technical Specifications

Standard Features

- Air clutches for torque control
- Variable speed tightening discs
- Spring loaded discs
- Timing belt driven
- Up to 200/min with 3 stations
- Up to 300/min with 4 stations

Available Options

- Reject station
- Motorized height adjustment
- 3-color light tower
- Spacing wheel and outfeed back-up sensor

Air & Electrical Requirements

- Power supply: 220VAC, 1 phase, 60Hz, 12A
- Air supply: 90 PSIG, less than 0.5 SCFM

Container and Cap Criteria

- Ideal for round, rectangular or oval plastic & glass containers
- Container height: from 2-1/2" (63mm) to 12" (305mm)
(min 2" (51mm) with slim belt)
- Container diameter: Min of 3/4" (18mm) Max of 6-1/4" (158mm)
- Cap type: standard screw or child proof (plastic or metal)
and snap cap
- Cap diameter: from 3/4" (18mm) to 6" (150mm)

Size

- Length: 3 ft. (0.91m)
- Width: 3 ft. (0.91m)
- Height: 5 ft. (1.52m)

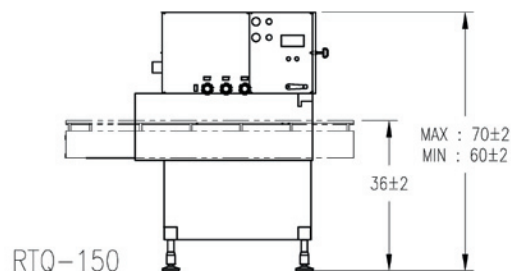
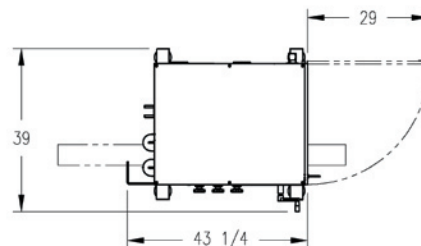

Floor Plan

Dimensions shown are for basic machines and may vary depending on options. In view of our policy of continuing research and product improvement, actual specifications may vary from those shown. Please consult with an NJM Packaging representative regarding your specific requirements.

All NJM Packaging equipment is covered by a one year warranty on parts. A comprehensive nationwide service, parts, and sales support program is available for the life of your equipment. A customized Preventative Maintenance Program for this equipment is also available.

Contact our Customer Service Department at (603) 448-3940 for more information.

This equipment can be purchased separately or as part of a fully integrated packaging line. Contact your sales representative for full details on other packaging equipment and complete turnkey line integration services.

Protected by one or more U.S. and foreign patents.

Authorized NJM Packaging Sales Representative



A Century of Packaging Expertise

USA 56 Etna Road
Lebanon, NH 03766 USA
1-800-432-2990

CANADA 5600 Kieran, Montreal QC
Canada H4S 2B5
1-800-811-6990
www.njmpackaging.com

Copyright © 2012 NJM Packaging

